

OPERATOR'S MANUAL

INCLUDING: OPERATION, INSTALLATION AND MAINTENANCE.

67440

67441

67440 & 67441 HANDLE KITS For 1-1/2", 2" and 3" metallic diaphragm pumps

RELEASED: 2-27-09
REVISED:
(REV. 01)



**READ THIS MANUAL CAREFULLY BEFORE INSTALLING,
OPERATING OR SERVICING THIS EQUIPMENT.**

It is the responsibility of the employer to place this information in the hands of the operator. Keep for future reference.
The original language of this manual is English.

67441 Handle Kit for 1-1/2" and 2" metallic models: 66615X-XXX-C 66620X-XXX-C

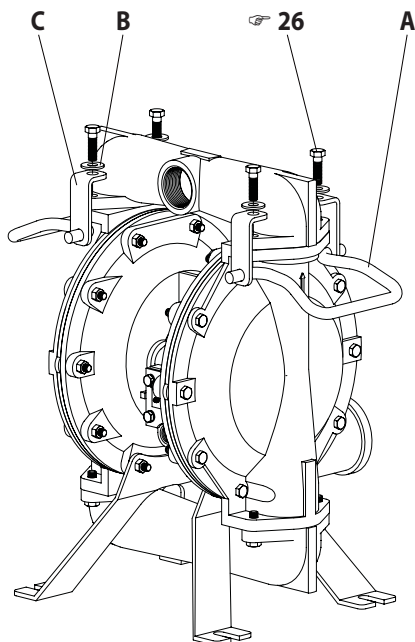

ASSEMBLY TORQUE REQUIREMENTS

NOTE: DO NOT OVERTIGHTEN FASTENERS.

(26) screw, 240 - 280 in. lbs (27.1 - 31.6 Nm).

67440 Handle Kit for 2" and 3" metallic models: 666250-XXX-C 666300-XXX-C

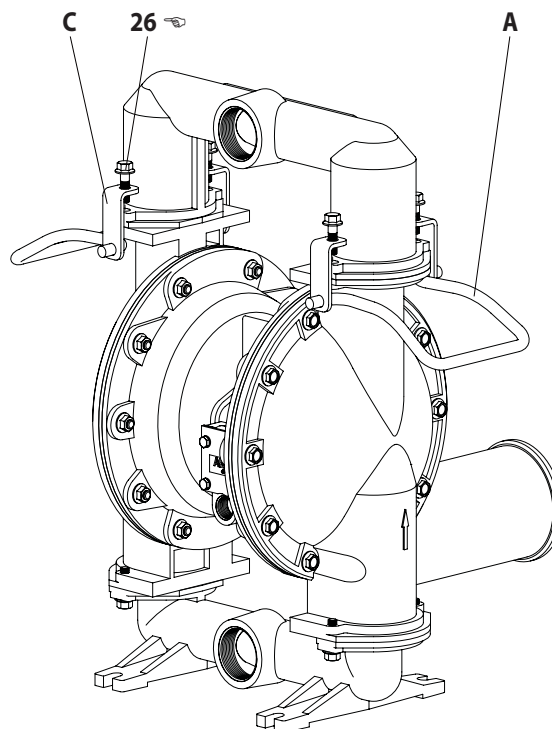

ASSEMBLY TORQUE REQUIREMENTS

NOTE: DO NOT OVERTIGHTEN FASTENERS.

(26) screw (models 666250-XXX-C), 30 - 40 ft lbs (40.7 - 54.2 Nm).
(26) screw (models 666300-XXX-C), 60 - 70 ft lbs (81.3 - 94.9 Nm).

6744X PARTS LIST

Item	Description (size)	Qty	Part Number
A	Handle (kit 67441)	(2)	97056
	(kit 67440)	(2)	97057

Item	Description (size)	Qty	Part Number
B	Washer (kit 67441 only)	(4)	Y13-6-C
C	Bracket	(4)	97055

PN 97999-1448

INGERSOLL RAND COMPANY LTD
P.O. BOX 151 • ONE ARO CENTER • BRYAN, OHIO 43506-0151
(800) 276-4658 • FAX (800) 266-7016
fluids.ingersollrand.com

© 2009

CCN 15327117

ARO

IR Ingersoll Rand
Industrial Technologies